

技术图表
Technical Data

SPP1612H

Serial number:

Version:04/2020

SANY PALFINGER SPV EQUIPMENT CO.,LTD
Rudong Development Zone, Nantong, Jiangsu, China
Service Hotline: +86 4008 878318
www.sanypalfinger.com

如果变更，必须把制造公差考虑在内。
 Subject to change, production tolerances have to be taken into account.

主参数信息	MAIN PARAMETER	SPP1612H
最大作业高度	Max. Working Height	15.8m
最大平台底高	Max. Platform Height	13.8m
最低平台底高	Min. Platform Height	1.56m
额定载荷CE/AUS标准	Rated Load/CE/AUS	230kg(P1+T150kg)
延伸平台载重	Rated Load on Extension Basket	120kg(P1+T40kg)
平台尺寸(长宽高)	Dimension of Basket (Length, Width, Height)	2.26×1.15×1.13m
延伸后平台长度	Length after Basket Extend Out	3.18m
整机尺寸(长宽高, 含梯子)	Dimension (Length, Width, Height) (Incl. Ladder)	2.46×1.2×2.5m
整机长度(不含梯子)	Length (Without Ladder)	2.27m
整机高度(护栏折叠)	Height (Basket Folded)	2.05m
整机重量CE/AUS标准	Weight (CE/AUS)	3330kg

运动工作参数	POWER AND OPERATION	SPP1612H
最小转弯半径	Min Radius of Turning Circle	2.3m
最大爬坡度	Gradeability	25%/14°
工作最大允许角度-纵横CE/AUS标准	Max Working Angle - Two direction (CE/AUS)	3°/1.5°
最大行走速度	Max Driving Speed	3.1km/h
起升后行驶速度	Driving Speed when Unfold	0.77 km/h
离地间隙	Ground Clearance	108mm
最小离地间隙	Ground Clearance with protection work	19mm
轴距	Axles Distance	1.875m
轮胎直径/宽度	Tyre Size Dia/Width	380/129mm
驱动轮数	No. of Driving Wheel	2
系统电压	Voltage	24V(12×2×2)
单电瓶容量	Single Battery Volume	150Ah/20h
电机功率	Motor Power	4.5kw

如果变更, 必须把制造公差考虑在内。
Subject to change, production tolerances have to be taken into account.

标准配置	STANDARD EQUIPMENT	SPP1612H
坑洞保护	Pit Protection	●
防夹手功能	Clamping Device when folding	●
倾斜保护	Working Angle Protection	●
自动限速	Auto Speed Limitation	●
行驶报警	Driving Warning	●
底座频闪灯	Strobe Lamp on Base	●
喇叭	Horn	●
高低速切换	Two Speed Switch	●
工作计时器	Hour Counter	●
电量计	Voltmeter	●
应急下降系统	Emergency Lower System	●
故障诊断功能	Fault Diagnosis	●
无痕橡胶实心轮胎	Non-marking Solid Tyre	●
远程监控	Remote monitor	●
可折叠围栏	Folding guardrail	●
免维护电瓶	Free maintenance battery	●
高压过滤系统	High pressure filtering system	●
平台旋转门	Rotate Door	●
选配配置	OPTION	SPP1612H
CE认证配置(已包含称重保护)	CE Certification Standard Configuration (Include Overload cut-off)	○
称重保护	Overload cut-off (Incl. Weight and Height mesurement)	○
平台电源插座	Electric Power Line to Platform	○
平台脚踏使能	Foot pedal enable to Platform	○
平台工作灯	Working Light on Platform	○
平台导气管	Air line to Platform	○
顶部防撞保护	Top Crashproof Protection	○
资料盒	Data box	○
平台测风仪	Wind speed detection	○
防碰撞报警/停止	Anti-collision system	○
液位检测 (邱健电池)	Liquid level detection(Only for Trojan battery)	○
锂电池配置	Li-battery	○

如果变更，必须把制造公差考虑在内。
 Subject to change, production tolerances have to be taken into account.

**Retracted Dimension
 收拢尺寸**

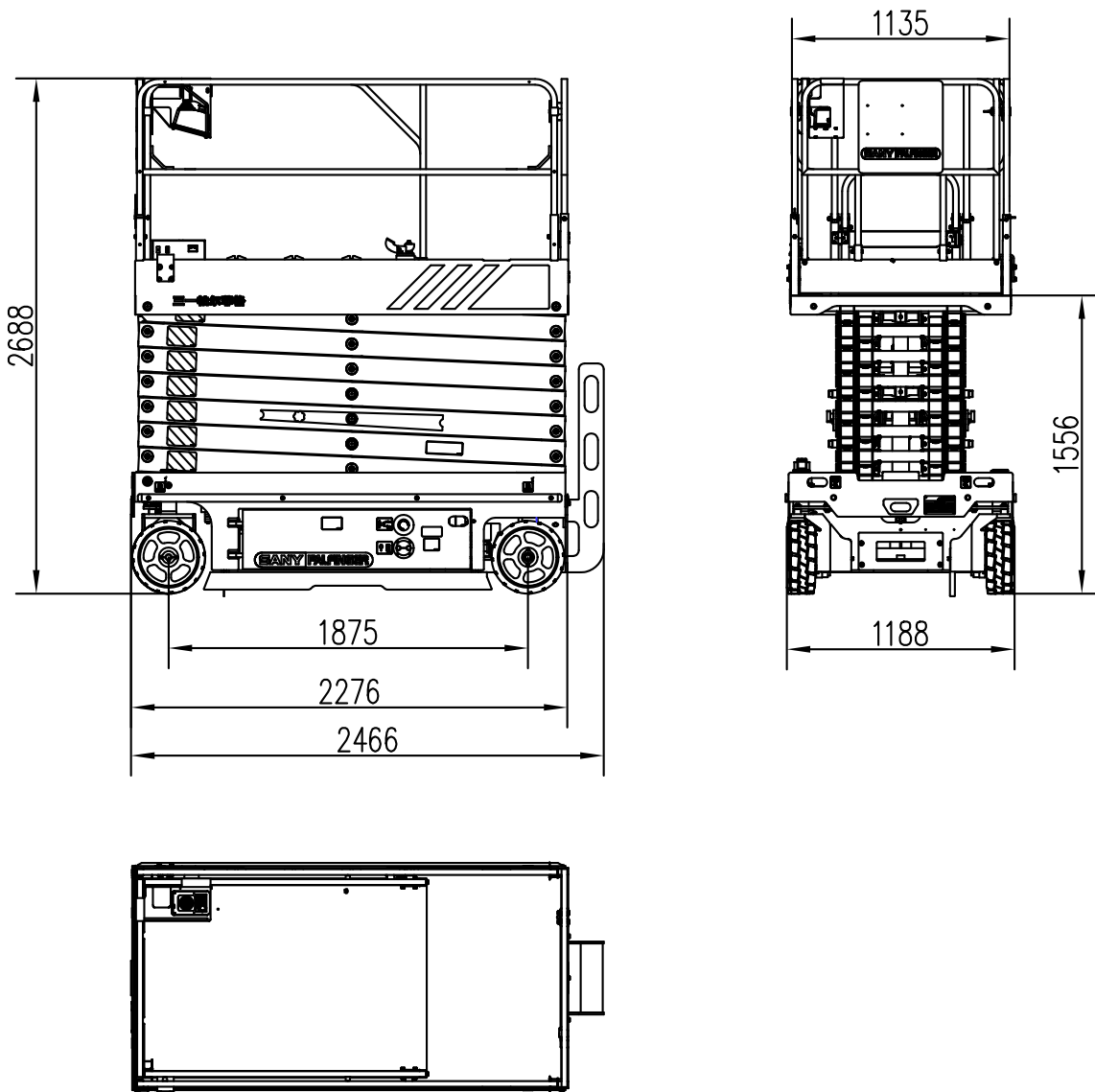

如果变更，必须把制造公差考虑在内。
Subject to change, production tolerances have to be taken into account.

Extended Dimensions
全伸尺寸

